



Quick Start Guide

Keep it Running Like New!

The blades of your new clipper and trimmer should be oiled every few haircuts. For best results, place three drops on front of the blades and one drop on each side of blade as shown. Use only the Wahl Clipper Oil included in the pack. Do not use hair oil, grease or any oil mixed with kerosene or any solvent.



Goof-Proof!

Adding Attachment Guards

Align guard onto blade then press down on guard where guard number is located until you hear a snap.

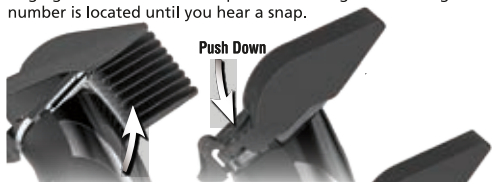

Removing Attachment Guards

From underneath, lift tab up to release from blade.



Blend it!

Use for blending between different hair lengths. The taper lever adds versatility to your clipper by allowing you to gradually change the closeness of your cut. (Up position = closest cut; Down position = longest cut)

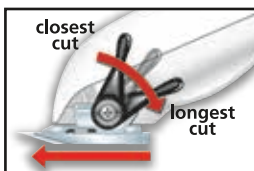

Not all clippers include a taper lever*

Keep Trim!



Trimmer cover flips up...



swings around front...



...and snaps into place, ready for detail work.

Use to trim around ears, neckline and sideburns



It's Easy!



Easy step-by-step instructions included. For more haircutting tips and techniques visit grooming.wahl.com.

Too Noisy?

(A) Oil blades as noted on this sheet.

(B) You can reduce the "clatter sound" by adjusting the power screw. The power screw was adjusted for peak efficiency before leaving the factory. However, if voltage in your home is too high or low, the clipper power screw may need adjustment.



Adjust Power Screw to Reduce Clipper Noise (excessive clattering)

1. Turn your clipper "ON"
2. Use the end of the cleaning brush or a screwdriver to turn power screw in a COUNTER CLOCKWISE direction until clatter goes away.

Max Power

Adjusting Power Screw for Maximum Power Setting

1. Turn your clipper "ON"
2. Use the end of the cleaning brush or a screwdriver to turn power screw in a CLOCKWISE direction until you hear a clattering noise.
3. Then turn power screw in opposite direction (COUNTER CLOCKWISE) until clattering stops.

Your New Clipper



Haircutting Tips & Techniques

Section 4: Top of the head

Section 3: The rim or side

Section 2: Under the rim of the head

Section 1: The neckline



When you cut your hair, you should visualize the head as if it were divided into four sections. Image below shows the different sections. Using proper techniques when moving from one section to the next will help you blend the sections together for professional looking results. See instruction book for more tips.

Helpful Hints

Use brush included to clean out excess hair on clipper and between blades (don't clean with running water)

SAFETY FIRST! Please read instruction book first before using clipper

If defective contact Wahl via 1-800-767-9245

WAHL®
HOME PRODUCTS

20 Piece Kit



NEW SMOOTH CUT GUARDS

NEW & IMPROVED
comb teeth for superior comfort
& cut quality

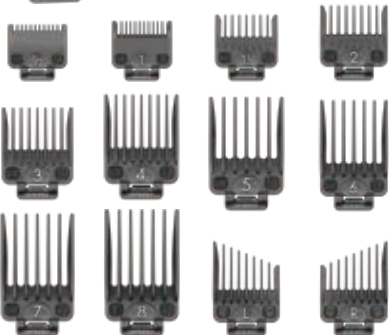

Clip 'N Trim®

CLIPPER & TRIMMER ALL-IN-ONE

Thank You!

Thank you for purchasing this Wahl clipper kit. We appreciate your support and we hope you enjoy your new clipper!

If you have any questions, please contact one of our USA based customer service representatives located next to our factory in Sterling, IL USA

www.grooming.wahl.com
1-800-767-9245



The Brand Used
By Professionals®

Quick Start Guide ▶