

Foil & Cutter Bar Assembly Replacement Instructions

©2022 Wahl Clipper Corporation

Art no. 3000080 v2021.11

To remove the foil head, push the shaver head release buttons on the sides of the shaver, and lift the foil head upward (Fig. A). Holding the shaver in one hand, gently pull up on each cutter bar. Be sure your thumb and first finger are positioned at each end of the cutter bar (Fig. B).

To replace the cutter bars, press down gently (Fig. C). Carefully replace the foil head, snapping it into place.



Instruction Book
Download

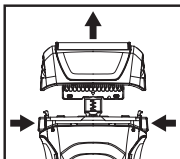

Figure A

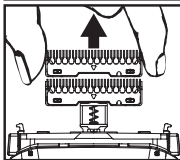

Figure B

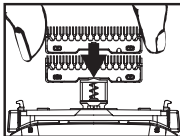

Figure C

Wahl Clipper Corporation
2900 Locust Street
Sterling, Illinois
Phone (800) 767-9245
Visit us at WahlUSA.com